

# Outdoor BBQ Kitchens



WE WILL  
DELIVER



WE WILL  
ASSEMBLE



SPECIAL  
ORDERS



AlfrescoPlus™

Available at  
**BUNNINGS**  
warehouse

Take This Brochure to the Special Orders Desk or order online at [bunnings.com.au](http://bunnings.com.au)

# AlfrescoPlus™



## Create Your BBQ Kitchen in 3D

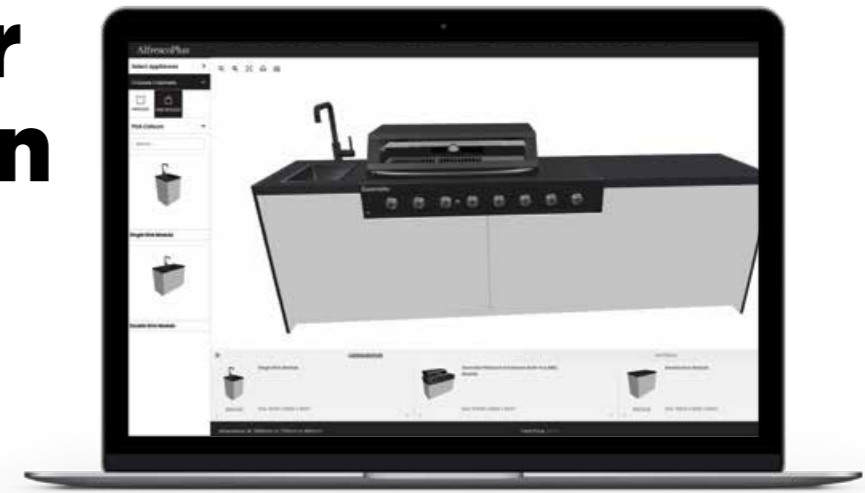

Release your inner designer and create your dream outdoor kitchen in 3D with our online outdoor kitchen planner.

When you have space outdoors, create your own outdoor kitchen with AlfrescoPlus™. No matter your aspirations, we've got the inspiration to help make it happen with our durable, modern and stylish modules that you can mix and match yourself.

So, make sure you have measured your space ... and you are now ready to use the software to design and plan your outdoor kitchen in 3D, in the comfort of your own home.

Once you have designed your AlfrescoPlus™ outdoor kitchen, you simply enter your details and a copy of your design, together with an estimate will be emailed to you.

### It's easy as!

All you then need to do, is take your design and estimate into your nearest Bunnings Store, head to the Special Orders Desk and place your order. Or you can also order online at: [www.bunnings.com.au/our-range/brands/a/alfrescoplus](http://www.bunnings.com.au/our-range/brands/a/alfrescoplus)

You will be relaxing in your alfresco area with your brand new AlfrescoPlus™ outdoor kitchen before you know it!



[www.create.alfrescoplus.com.au](http://www.create.alfrescoplus.com.au)

Create your own OUTDOOR KITCHEN

### It's easy as...

- STEP 1**  
**Measure Your Space**
- STEP 2**  
**Select Your Appliances**
- STEP 3**  
**Choose Your Cabinets**
- STEP 4**  
**Pick Your Colour**



Follow us on:  
 Facebook & Instagram  
 @alfrescoplus\_aus

[www.alfrescoplus.com.au](http://www.alfrescoplus.com.au)

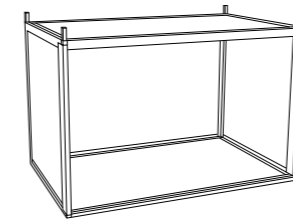

#### Pre-packaged Flatpack AlfrescoPlus™ DIY Range

The AlfrescoPlus™ Range makes it easy to get your outdoor BBQ kitchen setup. We've done the thinking for you, packing popular colour palettes with ready to go appliances making your install from start to finish achievable by the DIYer.

The modules are all delivered in a flat pack form for easy transport.

Check out the assembly videos on our website: [www.alfrescoplus.com.au](http://www.alfrescoplus.com.au)

#### AlfrescoPlus™ Aluminium Frame

The AlfrescoPlus™ aluminium framing system provides the backbone of our outdoor kitchens.

They harness the power of technological advances and engineering perfection, bringing together a patented cabinetry system that's unlike anything else on the market.

#### 100% Waterproof

When combined with waterproof PVC panels, AlfrescoPlus™ aluminium extrusions join seamlessly, forming a rigid and robust cabinetry solution that is almost 4 times quicker to construct than traditional cabinetry.

#### We Have You Covered

Backed by our friendly customer service and guaranteed warranties. We use quality materials and offer a 15 year structural warranty for your peace of mind\*. You don't need to worry about a thing.

It is recommended that your AlfrescoPlus™ Outdoor Kitchen is assembled, installed and positioned wholly under cover. This will protect it from the elements and UV rays and generally keep it cleaner.

AlfrescoPlus™ is a registered Trademark of Sitro Group Australia Pty. Ltd. 33 - 35 Lionel Road, Mount Waverley, VIC 3149

Material and design specifications subject to change without notice. Product colour reproduction is as near to actual product colour as production methods allow. AlfrescoPlus™ products in this brochure are the subject of registered designs and patents.



**NEW**  
3 DRAWER  
MODULE  
Refer to page 11

BELOW IMAGE:  
Modules from left to right:  
Double Sink Module - Arctic White  
Gasmate Platinum III 6 Burner BBQ  
Gasmate Platinum III 6 Burner BBQ  
Module - Arctic White  
**NEW Single 3 Drawer Module - Arctic White**  
Single Storage Module - Arctic White  
End Panels - Arctic White

ABOVE IMAGE  
Modules from left to right:  
Single Sink Module - Cadet Grey  
**NEW Single 3 Drawer Module - Cadet Grey**  
Gasmate SOHO Drop In 4 Burner BBQ with Hood  
Gasmate SOHO BBQ Module - Cadet Grey  
Matador Single Fridge  
Single Fridge Module  
End Panels - Cadet Grey



**NEW**  
3 DRAWER  
MODULE  
Refer to page 11

## STEP 1

# Measure Your Space

Your AlfrescoPlus™ outdoor kitchen can be made as small or as large as you like – to suit your alfresco area and your budget. The options are limitless.

Design your outdoor kitchen using our online 3D planner at [www.create.alfrescoplus.com.au](http://www.create.alfrescoplus.com.au) or use our measurement and grid system on page 22.

Every outdoor kitchen starts with a vision.

AlfrescoPlus™

Create  
your own  
OUTDOOR KITCHEN



## STEP 2

# Select Your Appliances

Australians love their barbecues and outdoor lifestyle. Our commitment to excellence in quality, design and both technical standards and innovation means that with AlfrescoPlus™ you can transform your outdoor space into a desirable alfresco area, perfect for entertaining. Choose your appliances for your alfresco kitchen from the extensive range at Bunnings.



LEFT IMAGE  
Gasmate SOHO Drop In  
4 Burner BBQ With Hood



Gasmate SOHO Drop In  
4 Burner BBQ With Flat Lid

**NEW**  
3 DRAWER  
MODULE  
Refer to page 11

## Market Leading Appliances

BBQ's, Fridges and Rangehood

AlfrescoPlus™

Gasmate

jumbuck

Beef Eater

MATADOR



GASMATE PLATINUM III  
6 BURNER BUILT IN BBQ  
**BQ1080BSL**  
I/N: 0388338  
To Suit: BBQ MODULE -  
1530mm

GASMATE SOHO  
DROP IN 4 BURNER BBQ  
WITH FLAT LID  
**BQ1096SL**  
I/N: 0388331  
To Suit: BBQ MODULE -  
1165mm



GASMATE SOHO  
DROP IN 4 BURNER BBQ  
WITH HOOD  
**BQ1096HKSL**  
I/N: 0388332  
To Suit: BBQ MODULE -  
1165mm

BEEFEATER 1600 SERIES  
5 BURNER BUILT IN BBQ  
**BBG1650SA**  
I/N: 0289455  
To Suit: BBQ MODULE -  
1060mm



MATADOR PALLADIUM  
4 BURNER BUILT IN BBQ  
**HS-19FB1400**  
I/N: 0348332  
To Suit: BBQ MODULE -  
915mm

MATADOR EDGE  
4 BURNER BUILT IN BBQ  
**GB0103L**  
I/N: 0348705  
To Suit: BBQ MODULE -  
895mm



MATADOR EDGE  
6 BURNER BUILT IN BBQ  
**GB0104L**  
I/N: 0348707  
To Suit: BBQ MODULE -  
1095mm

JUMBUCK ASTRO  
4 BURNER BUILT IN BBQ  
**SYGP4BB**  
I/N: 0348325  
To Suit: BBQ MODULE -  
915mm



GASMATE BBQ  
RANGEHOOD  
**GR1000**  
I/N: 0204745  
1200mm W x 445mm D  
x 700mm H

MATADOR SINGLE DOOR  
118L - STANDARD  
BAR FRIDGE  
**MF118FVI**  
I/N: 3171041  
505mm W x 505mm D  
x 850mm H



MATADOR DOUBLE DOOR  
228L - STANDARD  
BAR FRIDGE  
**MF228FVI**  
I/N: 3171042  
905mm W x 505mm D  
x 850mm H

## STEP 3

# Choose Your Cabinets

The AlfrescoPlus™ modules feature PVC panels which are impervious to water and won't crack, split or rot. And the patented aluminium frames make assembly easy for any DIYer. All modules come partially assembled, pre-packaged and flat-packed!

### BBQ Modules

There is a specific BBQ module in the AlfrescoPlus™ range that will suit your preferred BBQ. Once your BBQ is sorted, choose from single or double sink modules, fridges and storage modules, including a new 3 drawer module. The possibilities are endless!

All BBQ modules come with vented modules that comply to Australian standards for LPG cylinder storage. The AlfrescoPlus™ patented Air Frame system, included with every BBQ module, provides a thermal heat and fire proof shield between the BBQ and the cabinetry. There are also vents in the fridge modules to allow plenty of air ventilation.



Arctic White

- BBQ Module & Air Frame – 895mm**
- Suits: **MATADOR EDGE 4B BBQ**
  - 895mm W x 580mm D x 950mm H
  - 950mm total max height including adjustable feet and Air Frame
  - Air Frame: 730mm deep to allow for services\*

ARCTIC WHITE	APBBM895W	I/N:0208307
CADET GREY	APBBM895G	I/N:0208306
BLACK ONYX	APBBM895B	I/N:0208305



Arctic White

- BBQ Module & Air Frame – 915mm**
- Suits: **MATADOR PALLADIUM 4B BBQ OR JUMBUCK ASTRO 4 BURNER BBQ**
  - 915mm W x 580mm D x 950mm H
  - 950mm total max height including adjustable feet and Air Frame
  - Air Frame: 730mm deep to allow for services\*

ARCTIC WHITE	APBBM915W	I/N:0208304
CADET GREY	APBBM915G	I/N:0208302
BLACK ONYX	APBBM915B	I/N:0208299



Arctic White

- BBQ Module & Air Frame – 925mm**
- Suits: **FAMILY Q BUILT-IN BBQ**
  - 925mm W x 580mm D x 950mm H
  - 950mm total max height including adjustable feet and Air Frame
  - Air Frame: 730mm deep to allow for services\*

ARCTIC WHITE	APBBM925W	I/N:0404030
CADET GREY	APBBM925G	I/N:0404031
BLACK ONYX	APBBM925B	I/N:0404034



Arctic White

- BBQ Module & Air Frame – 1060mm**
- Suits: **BEEFEATER 1600 SERIES 5B BBQ**
  - 1060mm W x 580mm D x 950mm H
  - 950mm total max height including adjustable feet and Air Frame
  - Air Frame: 730mm deep to allow for services\*

ARCTIC WHITE	APBBM1060W	I/N:0298396
CADET GREY	APBBM1060G	I/N:0298395
BLACK ONYX	APBBM1060B	I/N:0298394



Arctic White

- BBQ Module & Air Frame – 1095mm**
- Suits: **MATADOR EDGE 6B BBQ**
  - 1095mm W x 580mm D x 950mm H
  - 950mm total max height including adjustable feet and Air Frame
  - Air Frame: 730mm deep to allow for services\*

ARCTIC WHITE	APBBM1095W	I/N:0208311
CADET GREY	APBBM1095G	I/N:0208309
BLACK ONYX	APBBM1095B	I/N:0208308



Arctic White

- BBQ Module & Bench top – 1165mm**
- Suits: **GASMATE SOHO DROP IN 4B BBQ WITH FLAT LID OR HOOD**
  - 1165mm W x 670 mm D x 950mm H
  - 950mm total max height including adjustable feet and Bench top
  - Bench top: 730mm deep to allow for services\*

ARCTIC WHITE	APBBM1165DIW	I/N:0298393
CADET GREY	APBBM1165DIG	I/N:0298391
BLACK ONYX	APBBM1165DIB	I/N:0298390

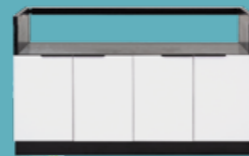

Arctic White

- BBQ Module & Air Frame – 1530mm**
- Suits: **GASMATE PLATINUM III 6B BBQ**
  - 1530mm W x 580mm D x 950mm H
  - 950mm total max height including adjustable feet and Air Frame
  - Air Frame: 730mm deep to allow for services\*

ARCTIC WHITE	APBBM1530W	I/N:0119421
CADET GREY	APBBM1530G	I/N:0119422
BLACK ONYX	APBBM1530B	I/N:0119424

### Single Modules



Arctic White

#### Single 3 Drawer Module

- Module: 550mm W x 580mm D x 950mm H
- 950mm total max height including adjustable feet and Bench top
- Bench top: 730mm deep to allow for services\* (see note below)

ARCTIC WHITE	APSDRMW	I/N:0388386
CADET GREY	APSDRMG	I/N:0388385
BLACK ONYX	APSDRMB	I/N:0388387



Arctic White

#### Single Storage Module

- Module: 550mm W x 580mm D x 950mm H
- 950mm total max height including adjustable feet and Bench top
- Bench top: 730mm deep to allow for services\* (see note below)

ARCTIC WHITE	APSDMW	I/N:0119657
CADET GREY	APSDMG	I/N:0119425
BLACK ONYX	APSDMB	I/N:0119426



Arctic White

#### Single Sink Module

- Module: 550mm W x 580mm D x 950mm H
- 950mm total max height including adjustable feet and Bench top
- Bench top: 730mm deep to allow for services\* (see note below)
- Includes matt black sink and tap (page 14 & 15)

ARCTIC WHITE	APSSMW	I/N:0119427
CADET GREY	APSSMG	I/N:0119428
BLACK ONYX	APSSMB	I/N:0119429



#### Single Fridge Module

- Module: 550mm W x 580mm D x 950mm H
- 950mm total max height including adjustable feet and Bench top
- Bench top: 730mm deep to allow for services\* (see note below)
- Vents at back of module

APSFM	I/N:0119658
-------	-------------

### Double Modules



Arctic White

#### Double Module

- Module: 960mm W x 580mm D x 950mm H
- 950mm total max height including adjustable feet and Bench top
- Bench top: 730mm deep to allow for services\* (see note below)

ARCTIC WHITE	APDDMW	I/N:0119430
CADET GREY	APDDMG	I/N:0119432
BLACK ONYX	APDDMB	I/N:0119659



Arctic White

#### Double Sink Module

- Module: 960mm W x 580mm D x 950mm H
- 950mm total max height including adjustable feet and Bench top
- Bench top: 730mm deep to allow for services\* (see note below)
- Includes matt black sink and tap (page 14 & 15)

ARCTIC WHITE	APDSMW	I/N:0119433
CADET GREY	APDSMG	I/N:0119434
BLACK ONYX	APDSMB	I/N:0119435



#### Double Fridge Module

- Module: 960mm W x 580mm D x 950mm H
- 950mm total max height including adjustable feet and Bench top
- Bench top: 730mm deep to allow for services\* (see note below)
- Vents at back of module

APDFM	I/N:0119660
-------	-------------

### End Panel Assemblies



Arctic White, Cadet Grey, Black Onyx

- End panels are needed to finish off your BBQ Kitchen cabinetry. Order them in the same colour as your cabinetry to ensure that your AlfrescoPlus™ BBQ kitchen is finished off correctly!
- 22mm W x 730mm D x 920mm H
- Pack of 2

ARCTIC WHITE	APCEP2PWHT	I/N:0119436
CADET GREY	APCEP2PGRY	I/N:0119437
BLACK ONYX	APCEP2PBLK	I/N:0119438

All modules are available in all 3 colours

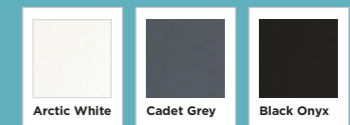

Refer to next page for more details.

\*PLEASE NOTE: Air Frame on BBQ modules and Bench tops on single and double modules are deeper than the modules to allow for services (gas, hot and cold plumbing, electrical cords and drainage) to run behind the outdoor kitchen when assembled. The legs on each module are designed to be adjusted for levelling.

## CUSTOMISATIONS

# Custom BBQ modules to suit your BBQ

Do you happen to have a different built in BBQ in mind to the various models on offer at Bunnings?

That's no issue at all. We can create Custom BBQ modules specifically designed and made to suit the size of most brands and models of built-in BBQs.

We've simplified the ordering process for you by creating two sizes of custom BBQ modules. The first, for BBQs up to 855mm wide, and the second, for those between 860mm to 1470mm wide.\*

When you order a Custom BBQ module for your AlfrescoPlus kitchen at the Bunnings Special Orders Desk, you must also detail to them the brand and model name / number of your BBQ.

Bunnings then place the order with us for your kitchen and we'll take care of it from there, and customize your BBQ module to suit your chosen BBQ!



Arctic White

### Custom BBQ Module & Air Frame - Suits BBQs up to 855mm wide

- Total max module: Up to 915mm W x 580mm D x 950mm H
- 950mm total max height including adjustable feet and Air Frame
- Air Frame: 730mm deep to allow for services\*

ARCTIC WHITE	APBBMCSTM1W	I/N:0421297
CADET GREY	APBBMCSTM1G	I/N:0421294
BLACK ONYX	APBBMCSTM1B	I/N:0421295

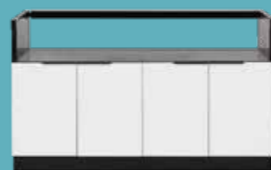

Arctic White

### Custom BBQ Module & Air Frame - Suits BBQs from 860mm to 1470mm wide

- Total max module: From 920 to 1530mm W x 580mm D x 950mm H
- 950mm total max height including adjustable feet and Air Frame
- Air Frame: 730mm deep to allow for services

ARCTIC WHITE	APBBMCSTM2W	I/N:0421298
CADET GREY	APBBMCSTM2G	I/N:0421293
BLACK ONYX	APBBMCSTM2B	I/N:0421296



Images on this page are indicative only. BBQ is not included.



Image is indicative only. BBQ is not included.

\*The total width of the custom BBQ module will be dependant on the size of your BBQ.

## STEP 4

# Pick Your Cabinet Colour

All modules come with a stunning UV stabilised black acrylic quartz bench top finish and can be fitted with a choice of 3 different colour compact laminate doors. All fitted with high quality hardware, levelling legs and kicker panels.

### Choice of 3 Colours

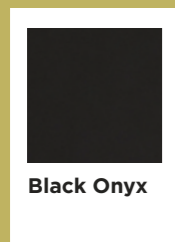
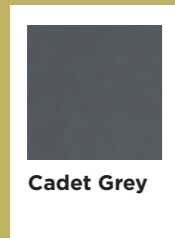

### Features

- Soft Closing Doors & Drawers
- Compact Laminate Door Finishes
- Kicker Panels

## Module Possibilities

Play around with the modules to create your very own design. Here are some possibilities ...

AlfrescoPlus™



Modules from left to right: Matador Double Fridge, Double Fridge Module, Double Storage Module - Cadet Grey, Gasmate Platinum III 6 Burner BBQ, BBQ Module - Cadet Grey, Single Sink Module - Cadet Grey and End Panels - Cadet Grey.

**NEW**  
3 DRAWER  
MODULE  
Refer to page 11



Modules from left to right: Single Sink Module - Arctic White, **Single 3 Drawer Module - Arctic White**, Matador Palladium4B BBQ, BBQ Module - Arctic White, Matador Single Fridge, Single Fridge Module and End Panels - Arctic White.

**NEW**  
3 DRAWER  
MODULE  
Refer to page 11



Modules from left to right: Single Sink Module - Black Onyx, **Single 3 Drawer Module - Black Onyx**, Gasmate Platinum III 6 Burner BBQ, BBQ Module - Black Onyx, Double Storage Module - Black Onyx and End Panels - Black Onyx.



## INCLUSIONS

# Benchtops, Taps, Sinks and Handles

**Finish on a high!** Designer Tap, Sink and Door Handle hardware to complete your outdoor kitchen.

AlfrescoPlus™ have combined high quality materials expected by the chef in all of us. Clean surfaces that are nice to touch and resistant to all BBQ cooking methods that take place over years of use.

Designed perfectly for busy gatherings, capable of creating spaces that make preparing food a pleasant experience that precedes the pleasure of sharing a meal with friends or family. These finishes represent beauty and solidity with easy, fuss free cleaning and what really matters is that you do not have to worry about scratches, stains or traces of heat. A simple wipe with a cloth is all it takes so you can spend more time entertaining.

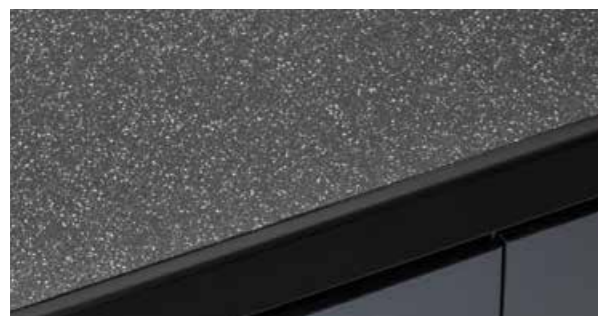

### Black Acrylic Quartz Benchtops

Resistant to scratching, virtually zero porosity and highly resistant to aggressive chemicals and high temperatures.



### Mixer Tap

Our AlfrescoPlus™ Gooseneck Matte Black WELS rated Mixer Tap gives your outdoor kitchen a modern, contemporary look and feel. The outdoor kitchen mixer tap is designed for full hands, the long spout enables you to use your elbow if you need to move the spout out of the way. The 360° swivel function makes this an efficient tap for your outdoor kitchen.

AlfrescoPlus™

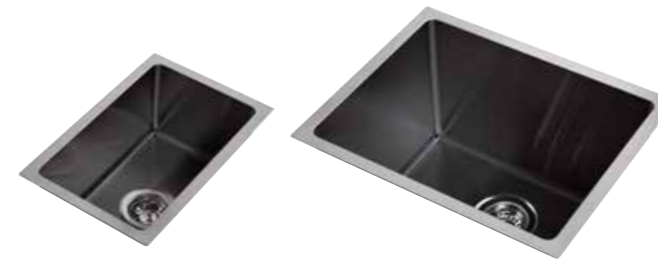

### Single and Double Sinks

Our AlfrescoPlus™ Matte Black single and double sinks are made from premium materials for a more robust finish and design.

#### Single Sink

OVERALL SIZE: 450x300x200mm

#### Double Sink

OVERALL SIZE: 500x400x300mm

### Handles

Black, ergonomic and elegant handles.

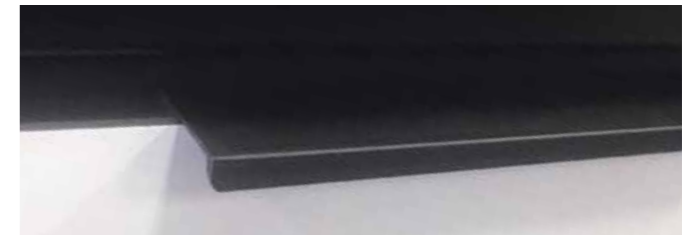

## AlfrescoPlus™ storage, sink, drawer and fridge module kits



### AlfrescoPlus™ Pre-Designed DIY Outdoor Kitchen Range

The ultimate outdoor kitchen solution for your outdoor alfresco area.

Our fabrications are second to none making your outdoor kitchen easy to measure, design and build.

*Imagine, design and create.*

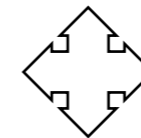

### Easy Assembly

Easy to follow, step by step guides and online assembly videos, taking your DIY experience to the next level.

The modules are supplied flat-packed and are easy to transport and assemble.



### Market Leading Appliances

An extensive range of market leading appliances - BBQs, Bar Fridges and a Rangehood are available - to make your dream outdoor kitchen a reality.

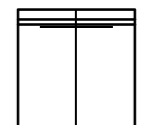

### Modules - Flexible In Configuration

There are single and double sink, fridge, drawer and storage modules in the range.

And various sized BBQ modules to suit your selected BBQ. Your outdoor kitchen can be made as small or large as you like - depending on your area and budget.

### Wels Rated

Standard AS/NZS 3718

Certification IAPMO

Model AQ56016YC

Certificate WM022545

WELS Licence 1547

WELS Registration

T30270

WELS Rating 4.5 Stars



AS/NZS3718  
WM022545  
IAPMO





LEFT IMAGE  
 Modules from left to right:  
 Double Sink Module - Cadet Grey  
 Matador Palladium 4 Burner BBQ  
 Matador Palladium 4 Burner BBQ  
 Module - Cadet Grey  
 Matador Single Fridge  
 Single Fridge Module  
 End Panels - Cadet Grey



LEFT IMAGE  
 Modules from left to right:  
 Single Storage Module - Cadet Grey  
 Gasmate SOHO Drop In 4 Burner  
 BBQ with Hood  
 Gasmate SOHO BBQ Module -  
 Cadet Grey  
 Matador Single Fridge  
 Single Fridge Module  
 End Panels - Cadet Grey

BELOW IMAGE  
 Modules from left to right:  
**NEW Single 3 Drawer Module - Black Onyx**  
 Double Sink Module - Black Onyx  
 Matador Edge 6 Burner BBQ  
 Matador Edge 6 Burner BBQ Module - Black Onyx  
 Matador Double Fridge  
 Double Fridge Module  
 Single Storage Module - Black Onyx  
 End Panels - Black Onyx





Modules from left to right:  
 Single Sink Module - Cadet Grey  
 Gasmate Platinum III 6 Burner BBQ  
 Gasmate Platinum III 6 Burner BBQ  
 Module - Cadet Grey  
 Matador Single Fridge  
 Single Fridge Module  
 End Panels - Cadet Grey



ABOVE IMAGE  
 Modules from left to right:  
 Double Sink Module - Black Onyx  
 Beefeater 1600 Series 5 Burner BBQ  
 Beefeater BBQ Module - Black Onyx  
 Matador Double Fridge  
 Double Fridge Module  
 End Panels - Black Onyx

LEFT IMAGE  
 Gasmate SOHO Drop In  
 4 Burner BBQ with Hood



# INSTALLATION

## Important Information

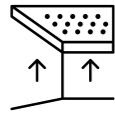

**1. UNDER COVER** - It is recommended that your AlfrescoPlus™ Outdoor Kitchen is assembled, installed and positioned wholly under cover. This will protect the unit from the elements and UV rays and generally keep it cleaner.



**2. STATE AND AUSTRALIAN STANDARDS** - When positioning the outdoor kitchen, it must conform to both State and Australian Standards. i.e. open ventilation and also distance to combustible surfaces. Refer to your BBQ instruction manual for more details.

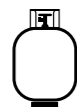

**3. LPG INSTALLATIONS** - If you choose to run your BBQ on LPG, we've got you covered. All BBQ modules come with vented modules that comply to Australian standards for LPG cylinder storage.

**4. ALTERNATIVE BBQS** - If the BBQs on offer through Bunnings do not suit your needs, or you already have a built-in BBQ that you would like to install in your AlfrescoPlus Outdoor Kitchen, we can produce Custom BBQ modules to suit most Brands & Models of built-in BBQs. Please Refer to pages 12 & 13 for more details. Alternatively, you can email us at [info@alfrescoplus.com.au](mailto:info@alfrescoplus.com.au) for further assistance.



**5. CROSS SECTIONAL SIDE VIEW to show service cavity** - All bench tops are deeper than the module that they sit on to allow for services - hot and cold plumbing, electrical cords and drainage - to run behind the outdoor kitchen when assembled.

The legs on each module are designed to be adjusted for levelling.

\*Note: All plumbing and electrical work must be carried out by a registered trades person.

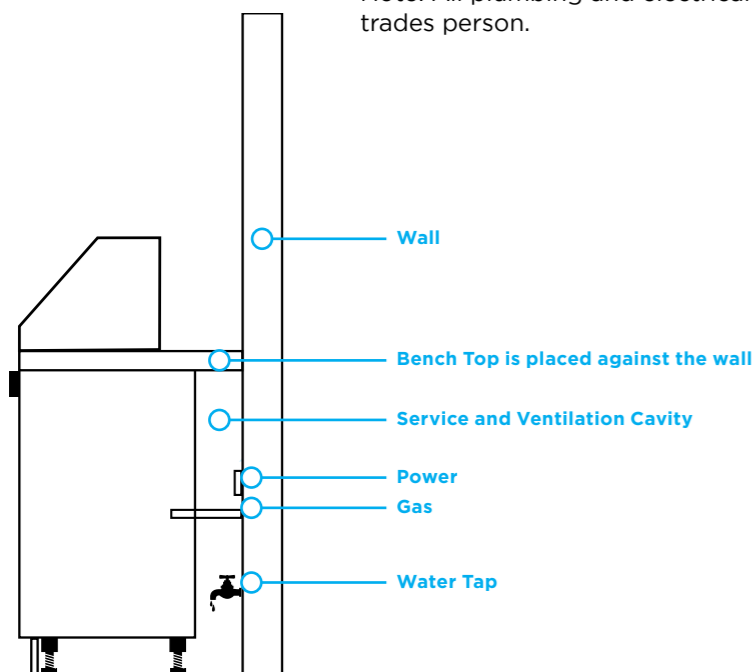

AlfrescoPlus™

# Grid System

It's easy with our measurement and grid system

**Start by:** Measuring and marking your alfresco dimensions using this grid as a guide for the layout of your outdoor kitchen. Make sure you calculate accurate measurements of modules and end panels. Use the measurements of modules below.

3m x 5m

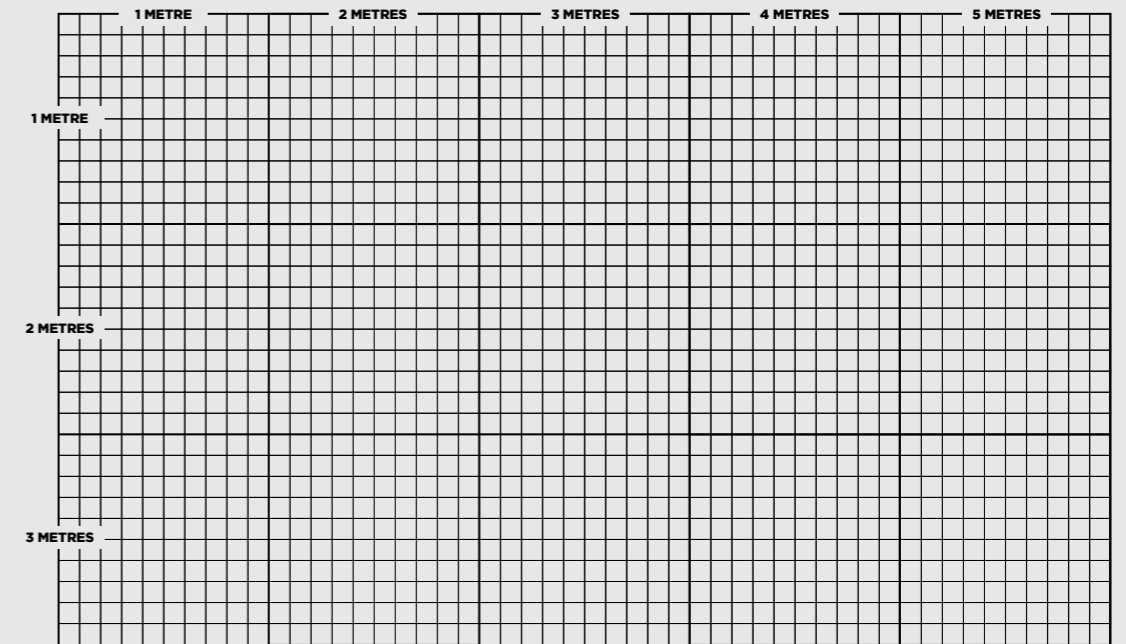

## BBQ Modules

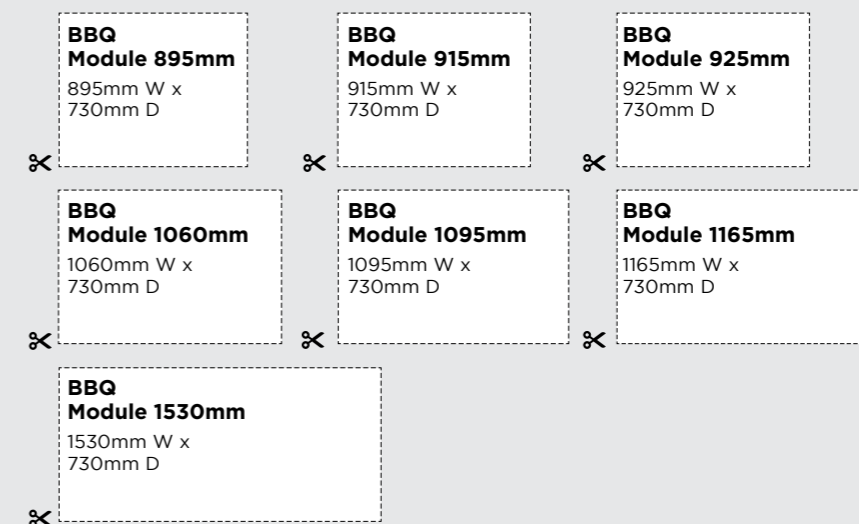

## Single Modules

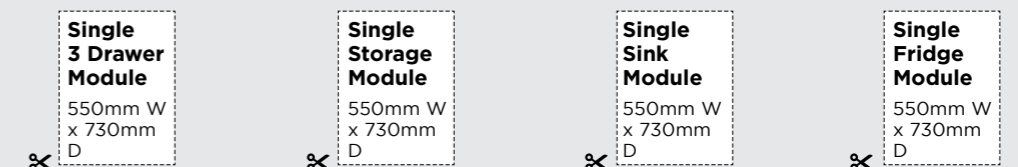

## Double Modules



## End Panels

**Don't forget your x2 end panels** - these are the easiest components to forget when designing an outdoor kitchen but are necessary to really finish off your kitchen.

**End Panels** 22mm W x 730mm D

# How It Works

---

It's as simple as 1,2,3! Follow the steps shown to purchase or order your product. If you need further advice, speak to a team member at the Special Orders Desk in-store.

---

## 1. Select The Product You Want

View the extensive range available in this brochure or online. Use the number shown below to order your product online or in-store.



---

## 2. Order Online or at the Special Orders Desk

After you have selected the product you want, take this brochure to the Special Orders Desk or order online at [bunnings.com.au](http://bunnings.com.au)

---

## 3. Get It Home

### We Will Deliver

Delivery to your home or site can be arranged online or in-store when purchasing your products.

### Pick-Up In-Store

If you decide to pick-up in-store and need help to get it home, you can:

- borrow a courtesy trailer
- hire a vehicle

Check with your local Bunnings store for availability.

---

